

ROHS

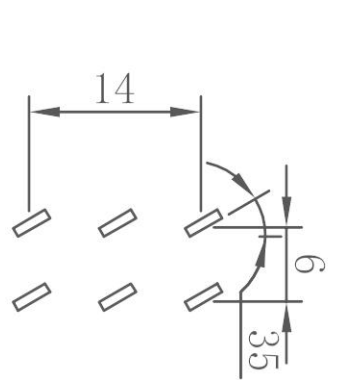

开孔尺寸

SCHEMATIC

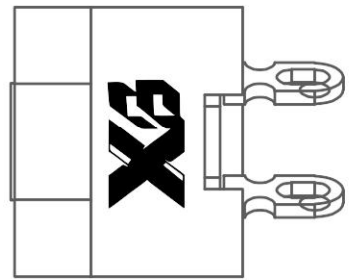
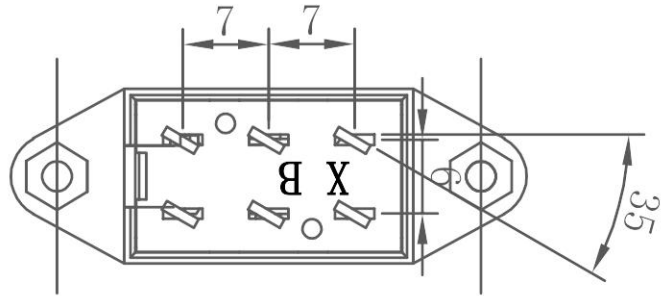
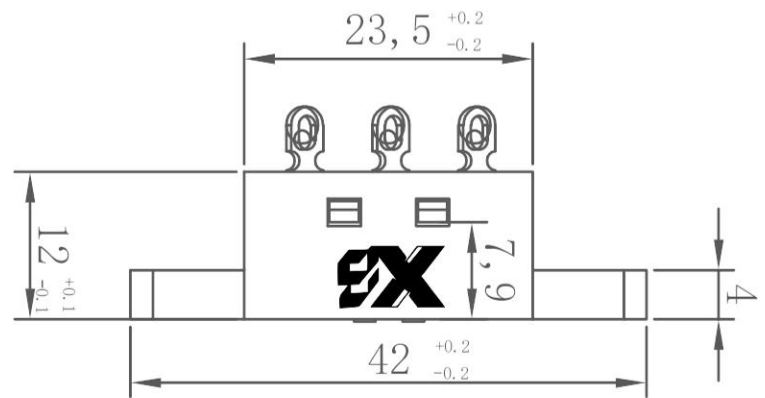
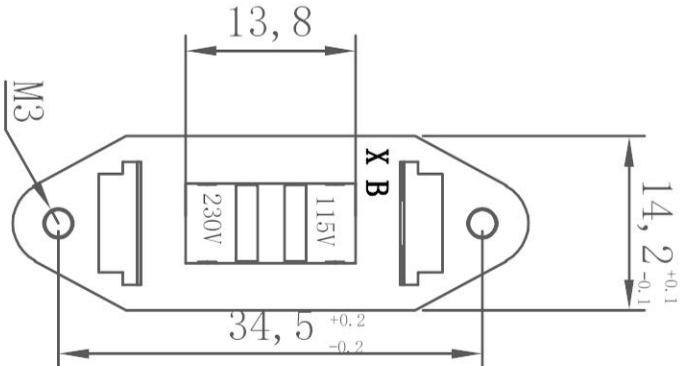
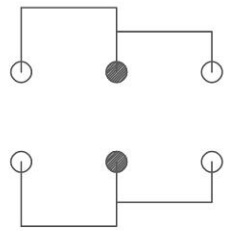

线路图

序号	名称	数量	材料
1	基座	1	PA66
2	推子	1	PA66
3	底板	1	PA66
4			
5	焊脚	6	黄铜电镀
6			
7	弹簧2	4	碳索钢丝
8	跳板	2	黄铜电镀

SPECIFICATION (INITIAL)				
RATING: 5A 10A 125V 250V AC				
CONTACT RESISTANCE: Not more than 30mΩ				
INSULATION RESISTANCE: 500MΩ at 1500V DC				
WITHSTAND VOLTAGE: AC 500V for 1 min				
OPERATION FORCE: 300±100g				
SWITCHING LIFE: 10000 Cycles (6-10c/m loading)				

The material contained in this drawing is the property of XiBang. Any use other than that specifically authorized by XiBang is prohibited. The above drawing IS subjected to change for improvement without prior notice.



东莞市溪榜电子有限公司
DONG GUAN XI BANG ELECTRONICS CO., LTD

TITLE : XB SLIDE SWITCH
MODEL : XB-PBS-110-E

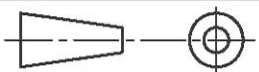

UNIT : MM	DWN.	ZENQ. CHEN	DATE	
SCALE : 3 : 1	CHK'D	PENG. GAO	DATE	
VBRSION	01	APPD.	FEI. LONG. HE	DATE

TOLERANCE
<=1.5mm±0.1
> 1.5mm±0.2
>=10mm±0.3

ANGLE
±2°

NO.	PART NAME	MATERIAL	QTY.	FINISHING
7	SPRING	STEEL WIRE	1	NATURE
6	STEEL BALL	STEEL	1	NATURE
5	BOARD	PHENOLIC RESIN	1	NATURE
4	CONTACT CLIP	PBS STRIP	2	Ag PLATED
3	FRAME	IRON STRIP	1	Ni PLATED
2	TERMINAL	BRASS STRIP	8	Ag PLATED
1	KNOB	POM	1	BLACK