

**SCHEMATIC**

**P.C.B LAYOUT**

**SPECIFICATION**

Contact Rating: 50mA, 12V DC  
 Contact Resistance: 100mΩ max  
 Insulation Resistance: 100mΩ min. 500V DC  
 Dielectric Strength: 250V AC/1minute  
 Travel: 1.2mm  
 Operating Temp: -30°C~+85°C  
 Storage Temp: -30°C~+80°C

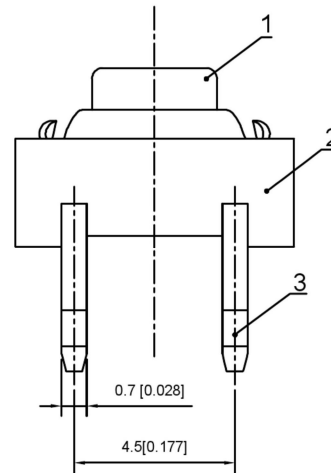
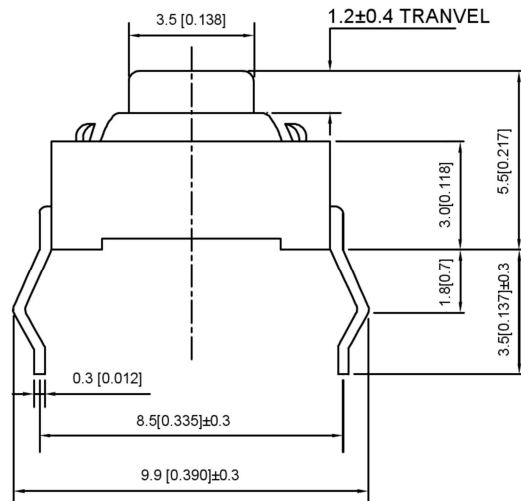

PAPT NO	TC-1117-X
Operating Force	B:120gf
Height	H:5.5

ITEM	PAPT NAMF	TER,NO	QTY	MATERIAL	FINISHING	REMARK
③	Terminal	—	4	Brass (0.30t)	Plating silvering	—
②	Base	—	1	Pa46	—	—
①	Keystake	—	1	Silica gel	—	—

DATE	REVISED	APPROVED	UNSPECIFIED TOLERANCES
			ANGULAR ±5°
			L ≤ 4 ±0.2
			4 < L ≤ 16 ±0.3
			16 < L ≤ 63 ±0.4
			L > 63 ±0.5



DSND	SCALE: N/A	MODEL TYPE: TACT SWITCH
DWN	VIEW:	PART NO.: TC-1117-X
CHKD	UNIT: mm/in	DWG NO.:
APPD	SIZE: A4	